

ASHTON

PUMPS LIMITED



www.ashtonpumps.com



issue 06.2009

RW50 (2") Aluminium - Sales & Engineering Data Sheet

Specifications

Maximum Free Flow - Water	568 lpm (150 US Gpm)
Maximum Working Pressure	7 Barg (100 Psig)
Inlet/Outlet Port Size/Standard	2" NPT/BSP Female
Air Valve Design	No Lube, No Stall
Air Inlet Size	1/2" NPT/BSP Female
Maximum Air Consumption	4.9 m ³ /min (175 scfm)
Maximum Dry Suction Lift - Water	5.5 metres (18 Feet)
Maximum Partical Size	6.3 mm (1/4 Inch)
Approximate Displacement/Stroke	3.9 Litres (1.03 US Gallons)
Typical Sound Level at 4.9 Bar (70 Psi)	78 dBa
Typical Working Temperature Limits	5 - 100 °C
Weight - Aluminium Construction	28 Kg (62 lbs)
Weight - Cast Iron Construction	58 Kg (128 lbs)
Weight - 304 & 316 St. Steel Construction	54 Kg (119 lbs)
Elastomer Options - Diaphragms/Valves	PTFE/Santoprene/Buna-N/Hytrek



Aluminium RW50 Pump

Performance Curve

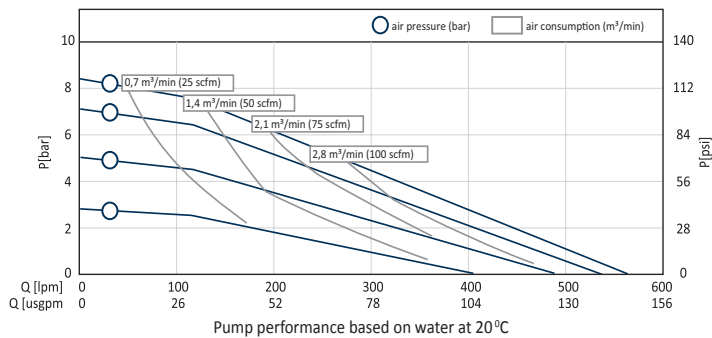

Dimensional Drawing

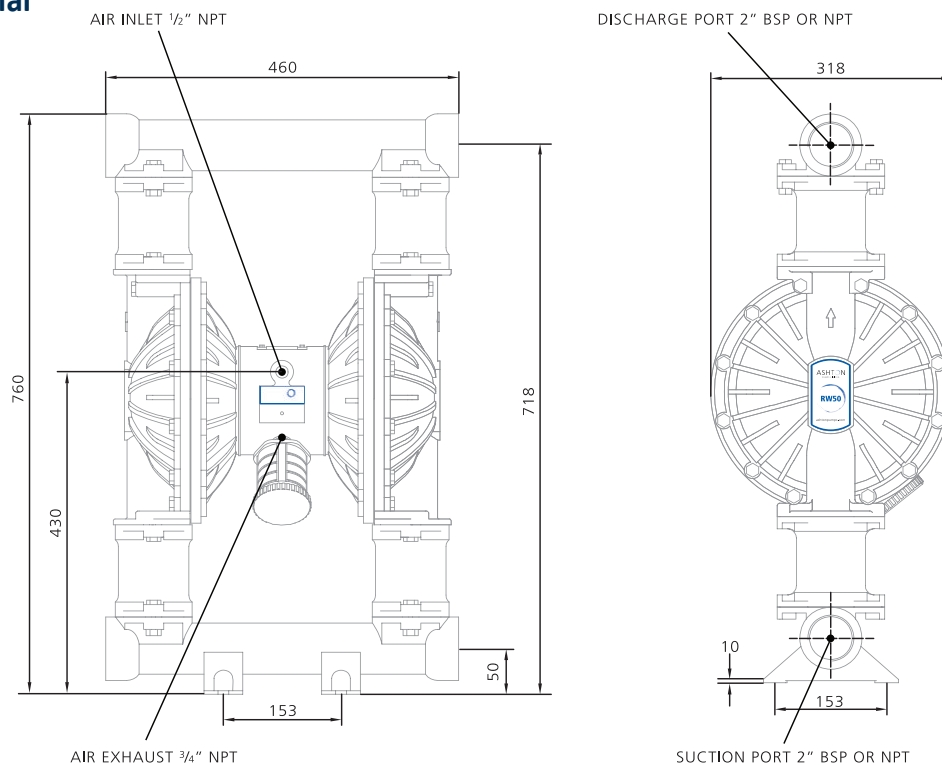

RW50 (2") Aluminium Sectional Drawing

KITS

- † Air Valve Repair Kit
- ‡ Wet Side Repair Kit

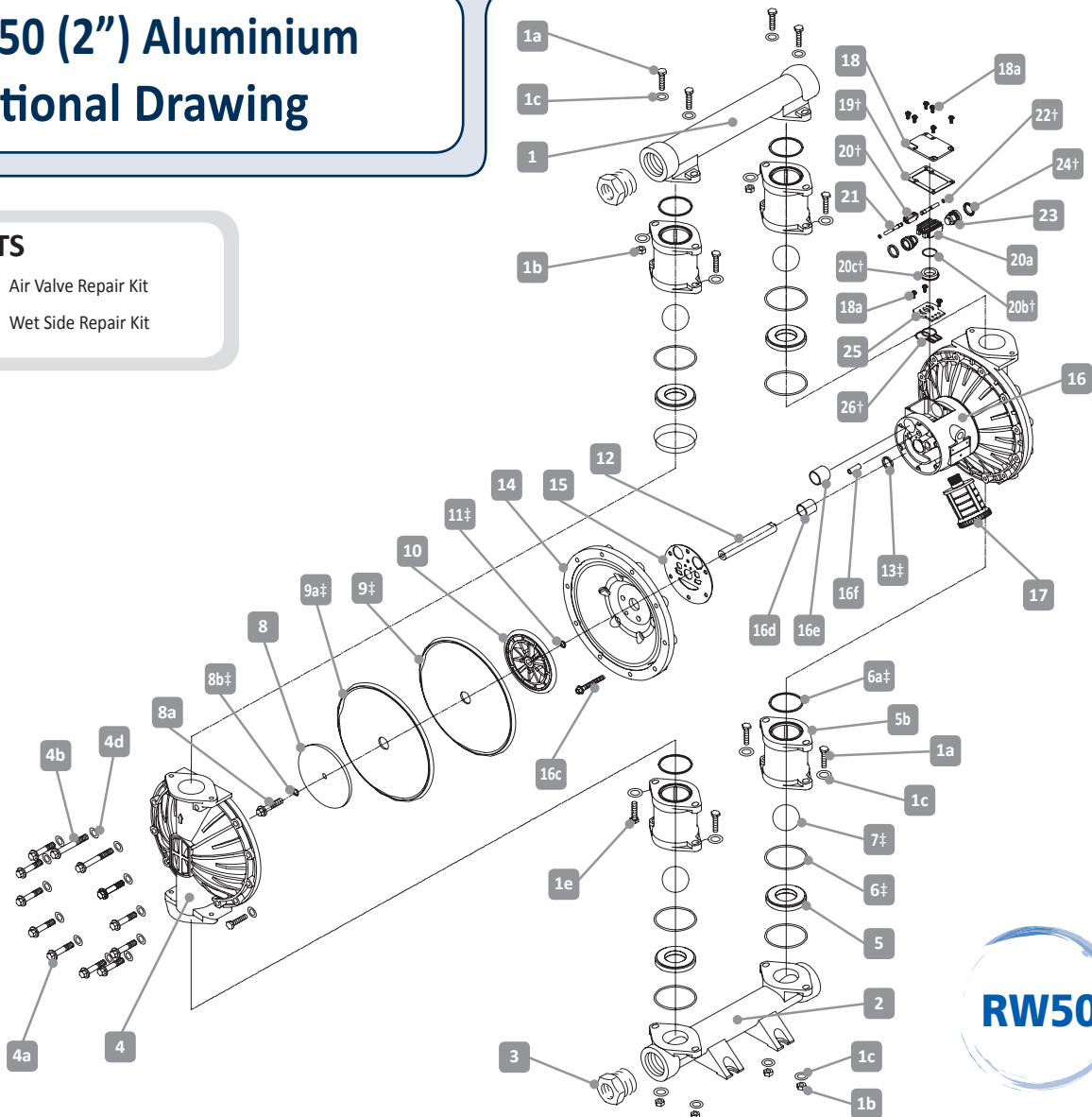

INDEX

1	Discharge Manifold	qty 1	8	Outer Piston	qty 2	17	Air Silencer	qty 1
1a	Bolt - Discharge/Suction Manifold	qty 8	8a	Outer Piston Bolt	qty 2	18	Air Valve Plate	qty 1
1b	Nut - Discharge/Suction Manifold	qty 8	8b‡	Outer Piston Bolt 'O' Ring	qty 2	18a	Air Valve Plate Screws	qty 9
1c	Washer - Discharge/Suction Manifold	qty 24	9	Rubber Diaphragm	qty 2	19†	Air Valve Plate Gasket	qty 1
1e	Bolt - Seat Spacer/Fluid Chamber	qty 8	9a‡	PTFE Overlay Diaphragm	qty 2	20†	Minor Carriage	qty 1
2	Suction Manifold	qty 1	10	Inner Piston	qty 2	20a	Major Carriage	qty 1
3	Manifold Plug	qty 2	11‡	Diaphragm Shaft 'O' Ring	qty 2	20b†	Major Carriage 'O' Ring	qty 1
4	Fluid Chamber	qty 2	12	Diaphragm Shaft	qty 2	20c†	Major Carriage Wear Ring	qty 1
4a	Bolt (Short) - Fluid Chamber	qty 16	13‡	Diaphragm Shaft U-Cup Seal	qty 2	21	Actuator Pin	qty 2
4b	Bolt (Long) - Fluid Chamber	qty 8	14	Air Chamber	qty 2	22†	Actuator Pin 'O' Ring	qty 2
4d	Washer	qty 24	15	Centre Body Gasket	qty 2	23	Piston	qty 2
5	Valve Seat	qty 4	16	Centre Body	qty 1	24†	Piston U-Cup Seal	qty 2
5b	Valve Seat Spacer	qty 4	16c	Air Chamber Screws	qty 12	25	St. Steel Wear Plate	qty 1
6‡	Valve Seat 'O' Ring	qty 8	16d	Diaphragm Shaft Bearing	qty 2	26†	Valve Plate Gasket	qty 1
6a‡	Valve Seat Spacer 'O' Ring	qty 4	16e	Piston Bearing	qty 2			
7‡	Valve Ball	qty 4	16f	Actuator Pin Bearing	qty 2			